

Brillite Forklift Safety Lamps

Dec 2019

FS90 & FS97 Series

FEATURES

- **Operation Voltage**
10-80VDC
- **Power**
14watts
- **LEDs**
amber/red: 1*10w
blue: 1*6w
- **Lens**
Polycarbonate
- **Housing**
Die-cast Aluminum
- **Mounting Type**
Swivel bracket
- **Waterproof**
IP67
- **Operating Temperature**
-40°C ~ +65 °C
- **Storage Temperature**
-20°C ~ +65 °C
- **Weight**
FS90 series: 0.65kg
FS97 series: 0.53kg
- **Package**
Box: 115*100*170mm
Carton: 360*316*360mm
18 pcs/carton
- **Cable Length**
500mm
- **Approval**
ECE R10



FS9020 

FS9030 

FS9050 



FS9720 

FS9730 

FS9750 

Brillite introduces energy efficient lighting with LED technology in our multi-volt LED forklift safety lamps.

This forklift safety lamp incorporates a long-life LED light source. Using a dedicated LED driver with pulse width modulation constant current supply combines to produce a long lasting, low power consumption and environmentally friendly LED lamp.

All models are suitable for various types of forklift.

BRILLITE
Electronics Technology Co., Ltd.

www.brillitelamps.com

Exploded diagram & drawing

FS90

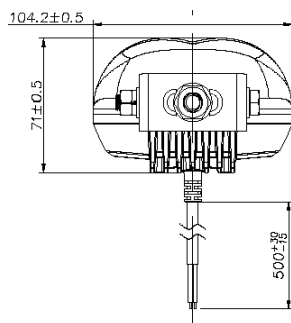
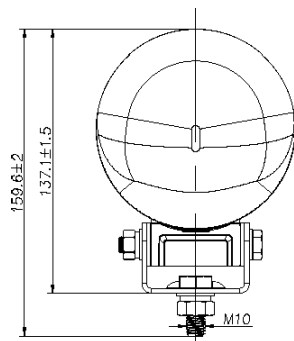

FS97

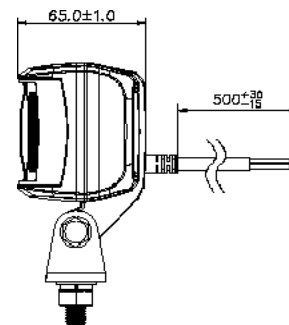
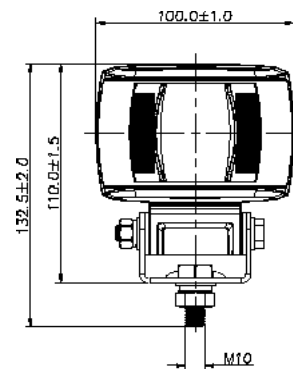

Wiring guide

Red wire: Positive (+)

Black wire: Negative (-)

BRILLITE

T: +86-20-8370-2610
F: +86-20-8370-2310
E: info@brillitelamps.com